



FILTER BAG CAGES AND VENTURIES

MOC: Mild Steel / Stainless Steel

Thickness: 3mm / 4mm

Design: Straight Wire Type / Spiral / Distance Mat / Custom Design

Venuri: Spun / Cast

The cages are a vital support system for the bags in a dust collector. Their design in terms of dimensions, finish, aesthetics play an important role in the life and performance of the filter bag. The venturies are mounted on top of the cages to direct the compressed air from the solenoid valves all along the length of the filter bag for effective cleaning.

PULSE JET SOLENOID VALVES

MAXTHERM (INDIA) PRIVATE LIMITED offers high quality solenoid valves to purge compressed air into the filter bags in on-line reverse pulse Jet dust collector systems.

Features:

- Precision Aluminium Die Cast Body
- Hytel Diaphragm (Single for 25NB and Double for 40 NB)
- Larger Exhaust Area for Low Noise
- Solenoid Capable of turning 360 deg

Fluid Temperature 5 to 85 deg C

Working Pressure 0.5 to 8 Bar

IP67 Rated

CE Certified

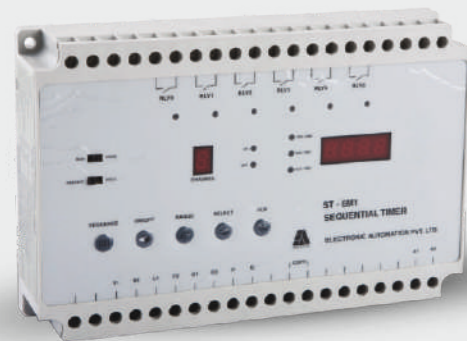

SEQUENTIAL TIMERS

MAXTHERM (INDIA) Private Limited offers reliable sequential timers to control the pulsing cycle of solenoid valves in a dust collector system. The capacity of specifications of this product depends upon the number of solenoid valves and desired "on time" and "off time" in the system.

FULL FLEDGED SALES AND SERVICE NETWORK IN INDIA & ABROAD

Erode - Madurai - Tirupur - Trichy - Bangalore - Cochin - Hyderabad - Mumbai
New Delhi - Pune - Bhubaneswar - Burdwan - Kolkata - Raipur - Guwahati - Vizag
Srilanka - Myanmar - Malaysia - Bangladesh - Thailand - UAE



AN ISO 9001: 2015 CERTIFIED COMPANY

MAXBAG

FULLY AUTOMATIC BAG FILTER



MAXTHERM (INDIA) PRIVATE LIMITED

MAXTHERM HOUSE

New No: 28/1 Old No: 38/1 Ganpathraj Nagar Main Road, Virugambakkam, Chennai - 600 092.

Tele: 044 - 2377 5911 / Mobile: +91 94983 70061 Email : sales@maxthermindia.com / info@maxthermindia.com

Web : www.maxthermindia.com



PIONEERS IN ENERGY AND ENVIRONMENT

BAG FILTER

(POLLUTION CONTROL EQUIPMENT)

BAG FILTER is a pollution control Equipment to maintain the Pollution control norms
As per Spm Level <math>< 50 \text{ mg} / \text{nm}^3</math>

BAG FILTER Consisting of :

- ▶ Casing & Hopper Assembly
- ▶ Bags (no. Of Bags Based On The Flue Gas Volume)
- ▶ Cages
- ▶ Rotary Air Lock Valve
- ▶ Inlet & Outlet Flanges
- ▶ Solenoid Valves
- ▶ Sequence Controller
- ▶ Panel Board

Emission Commitment :

SPM level : Less than <math>< 50 \text{mg} / \text{Nm}^3</math>

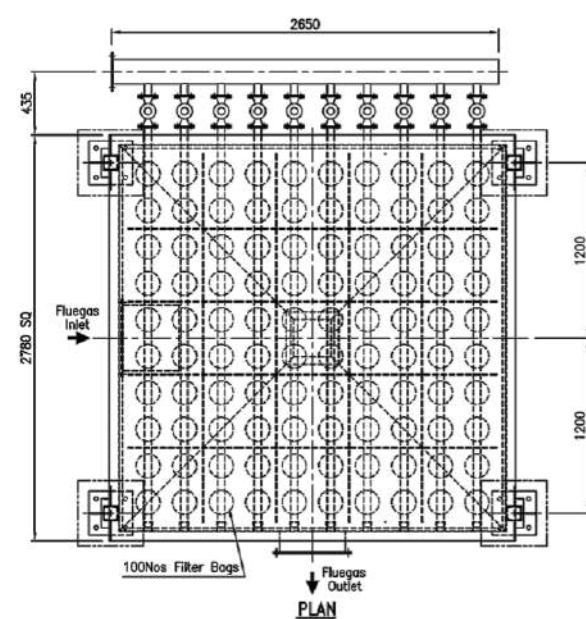
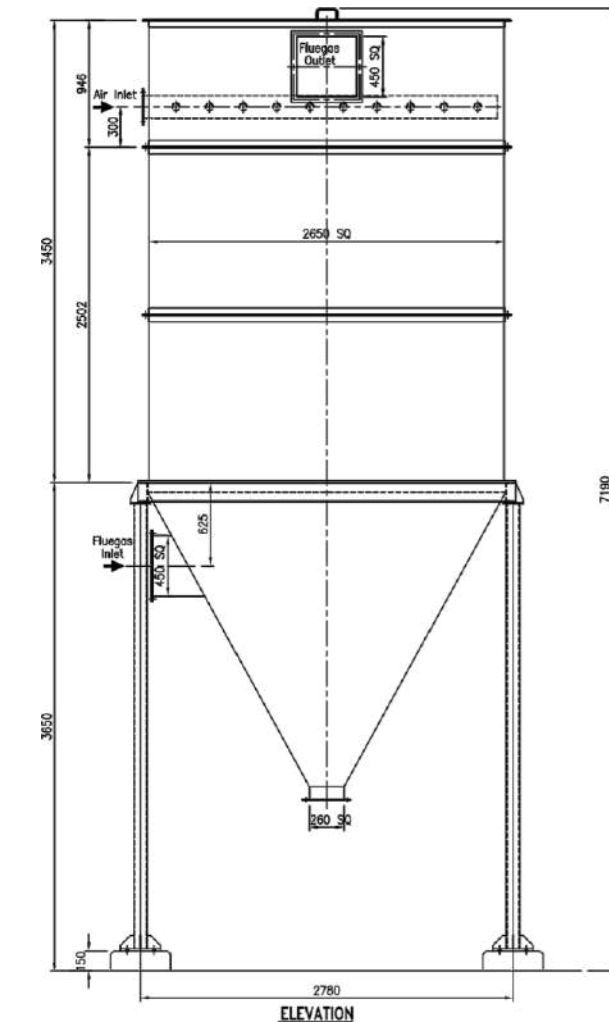

CONVENTIONAL DUST COLLECTOR FILTER BAGS

The dust collector filter bags are manufactured using “non-Woven Needle Felt media”. Working on the depth filtration technology, this material is characteristic of its low air permeability. The fibres are punched in a high speed needle loom, with a support scrim at the centre to produce a stable fabric, suitable for industrial dust filtration.

Media	Temp Resistance	Hydrolysis Resistance	Acid Resistance	Alkali Resistance	Remarks	Applications
Polyester	Cont: 130 deg C Peak: 140 deg C	Poor	Good	Fair	Dry Conditions upto 130 deg C. High Alkaline content is a problem	Cement, iron, Steel, Pigments, Powder Coating, Asbestos, Wood, Plastics
Polypropylene	Cont: 90 deg C Peak: 95 deg C	Good	Good	Good	Moist Conditions upto 90 deg C and hygroscopic dusts as low temp	Detergents, Fertilizers, Fodder, Milk Powder, Sugar, Flour, Chemical Industry
Acrylic (Homopolymer)	Cont: 130 deg C Peak: 140 deg C	Good	Good	Fair	Moist conditions upto 130 deg C. An alternative to Polyester for hydrolysis	Asphalt Mixing, Boilers, Spray Dryers, Gypsum, Cement, Lime, Paints
PPS (Ryton)	Cont: 170 deg C Peak: 180 deg C	Good	Good	Good	Applications with max cont temperature of 170 deg C under increased chemical attack	Coal Fired Boilers, Gypsum, Chemical Industries
Aramid (Nomex)	Cont: 200 deg C Peak: 210 deg C	Fair	Poor	Good	Dry and Hot conditions upto 200 deg C	Iron, Asphalt, Sponge Iron, Cement, Ceramic, Furnaces
Polyimide (P84)	Cont: 200 deg C Peak: 220 deg C	Poor	Good	Fair	Dry and Hot conditions upto 200 deg C above dew point. Low emissions	Incinerators, Chemical Industry, Coal Fired Boilers
PTFE (Teflon)	Cont: 250 deg C Peak: 280 deg C	V Good	V Good	V Good	Dry and very Hot conditions upto 250 deg C under severe chemical attack	Incinerators, Smelters, Oil & Coal Fired Boilers

COATINGS AVAILABLE

- ▶ Oil and Water Repellant Coating
- To handle Sticky Dust
- ▶ Antistatic Coating
- For conducting static electric charge

BAG DESIGNS

- ▶ Snap Band Type
- ▶ Collar Type
- ▶ Clamp Type
- ▶ Cassette Type
- ▶ Rope Type
- ▶ Other Custom Designs